

# SWC型(Type)



**6C**



**6CE**



**6CF**



**6CG**



**OM6CH**

## 装配尺寸 Fitting Dimension

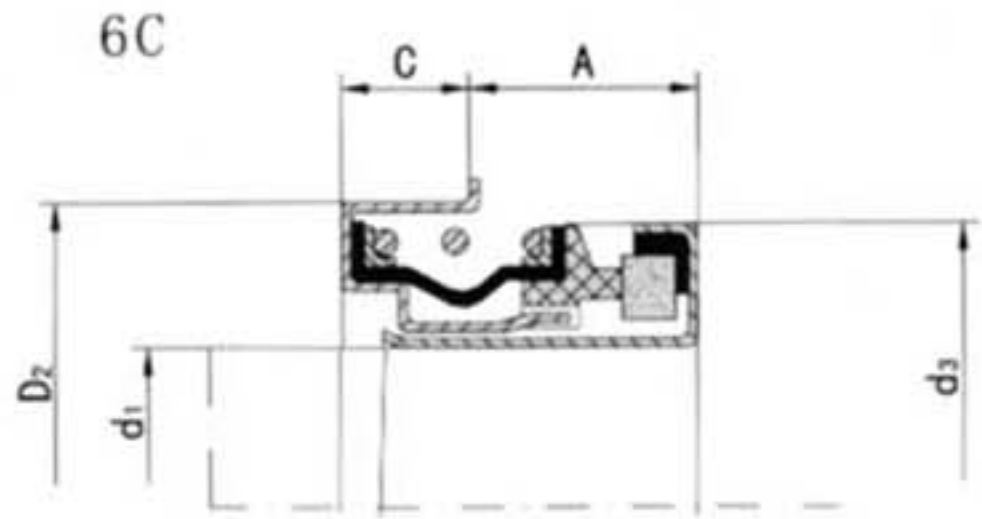

规格 (Specification)	尺寸 (Size)	d <sub>1</sub>	d <sub>3</sub>	D <sub>2</sub>	A ±0.20	C
6C-12		12	26.5	30	9.7	8
6C-13		13	26.5	30	9.7	8
6C-15		15	28.5	30	11	8
6C-16		16	31	36.5	12.2	8

配套车型: OM6C-12配重庆长安微型车,  
OM6C-16配东汽神龙。

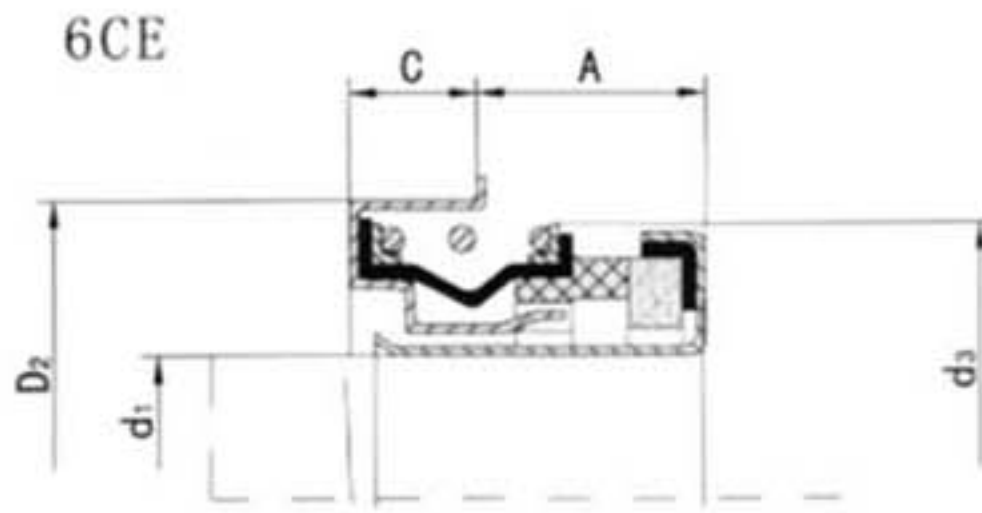

规格 (Specification)	尺寸 (Size)	d <sub>1</sub>	d <sub>3</sub>	D <sub>2</sub>	A ±0.20	C
6CE-12		12	27	33.45	8	8.8
6CE-12A		12	27	33.45	9.4	7.5

配套车型: 6CE-12配南汽轿车  
6CE-12配东汽轻卡。

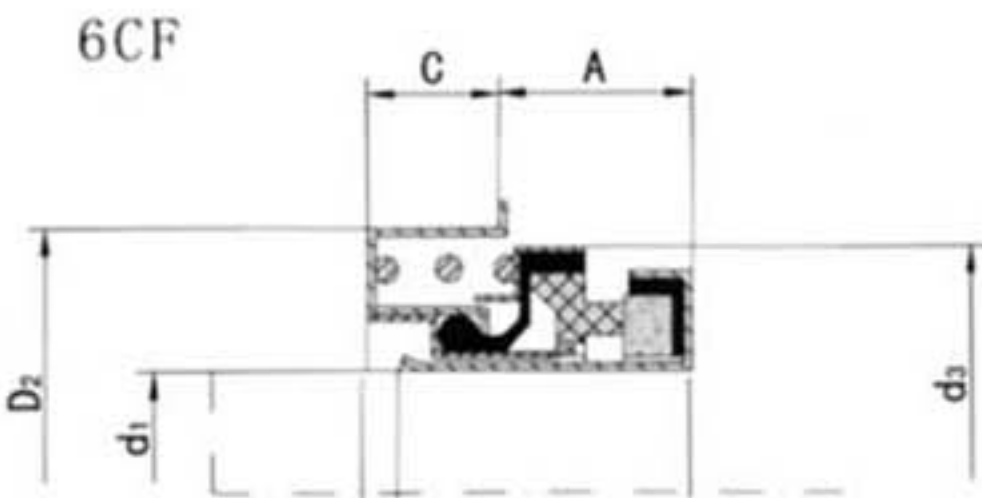

规格 (Specification)	尺寸 (Size)	d <sub>1</sub>	d <sub>3</sub>	D <sub>2</sub>	A ±0.30	C
6CF-16		15.91	33.4	36.462	11.3	9.5

等同克兰6A组合式密封。  
Comparable to John Crane Type (6A combined Mechanical seals.)  
配套车型: 6CF-16配东汽康明斯。

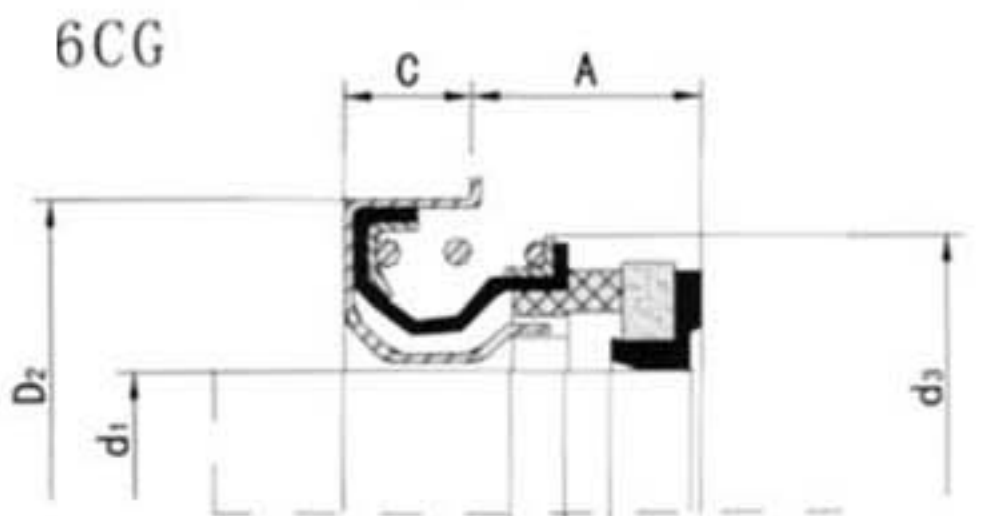

规格 (Specification)	尺寸 (Size)	d <sub>1</sub>	d <sub>3</sub>	D <sub>2</sub>	A ±0.30	C
6CG-16		16	29.5	36.63	11.75	8

配套车型: 配大众普桑。

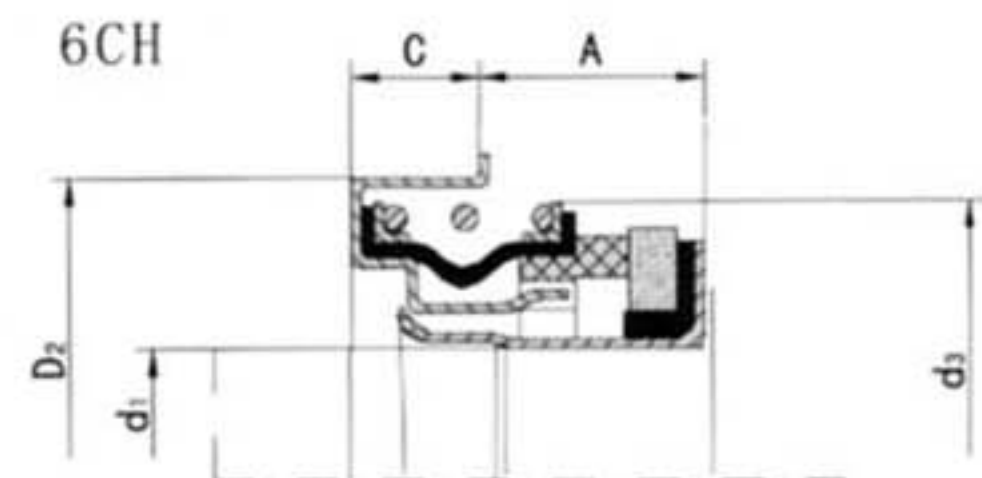

规格 (Specification)	尺寸 (Size)	d <sub>1</sub>	d <sub>3</sub>	D <sub>2</sub>	A ±0.15	C
6CH-16		16	32.6	34.29	12.34	7

配套车型: 配一汽小红旗。

# SW B型(Type)



**6B**



**6SB**

## 装配尺寸

Fitting Dimension

**6B**

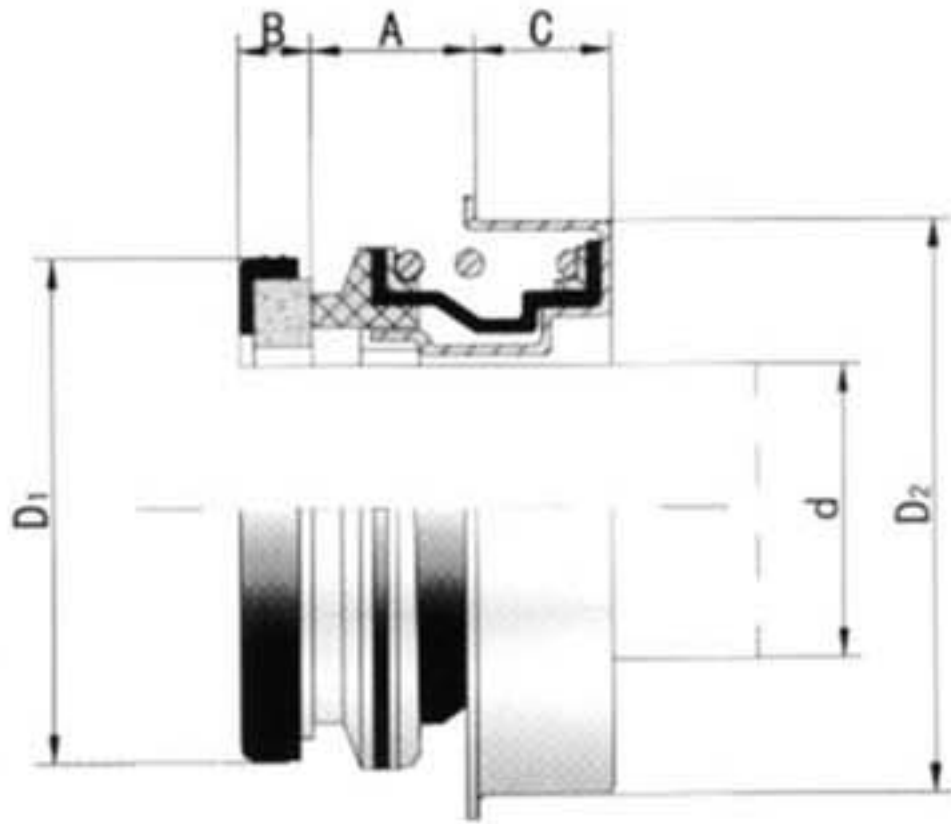

规格 (Specification)	尺寸 (Size)	d	D <sub>1</sub>	D <sub>2</sub>	A (±0.015)	B	C (max)
6B-3/8"		0.375	0.875	1.125	0.165	0.160	0.310
6B-1/2"		0.500	1.000	1.125	0.187	0.218	0.312
6B-5/8"		0.625	1.187	1.437	0.265	0.281	0.312
6B-3/4"		0.750	1.375	1.575	0.265	0.375	0.350

Cross reference to PAC seal Type 68, John crane Type 6A.  
(等同PAC 68型, 克兰6A型)

规格 (Specification)	尺寸 (Size)	d	D <sub>1</sub> (H8)	D <sub>2</sub> (H8)	A (±0.30)	B	C (max)
6B-10		10	23	24	4.2	4	8
6B-12		12	25	28.58	4.7	5	8
6B-16		16	30	36.5	6.8	5	8
6B-20		20	35	40	6.8	5	9.5

**6SB  
SB**

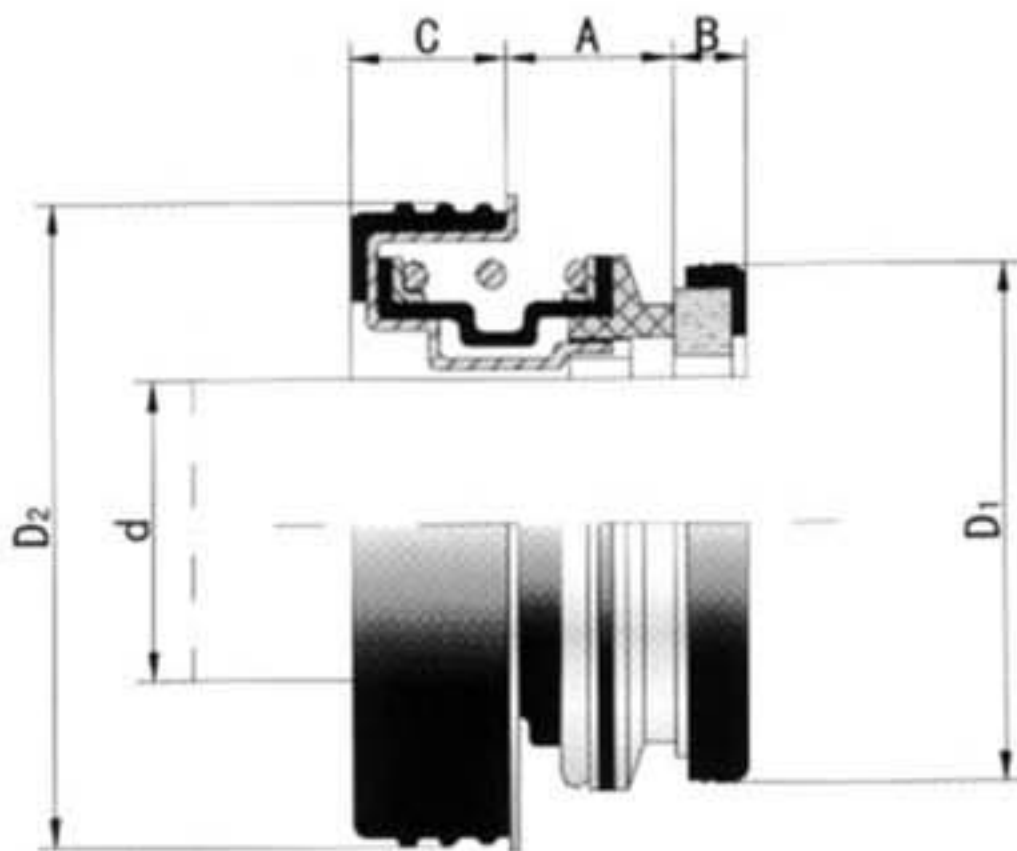

规格 (Specification)	尺寸 (Size)	d	D <sub>1</sub> (H8)	D <sub>2</sub> (H8)	A (±0.30)	B	C (max)
SB-10		10	23	27	5.5	5	7.5
SB-12		12(13)	25	30	6	5	8.5
SB-17		17(16)	30	35	9	7	9.5
SB-20		20	36	40	12	7	9.5
SB-25		25	42	50	10.5	8	13.5
SB-28		28	45	54	10	8	11.5

配套车型: SB-12配哈飞微型车, SB-17配EQ、CA系列中卡,  
SB-20配C6135柴油机。

规格 (Specification)	尺寸 (Size)	d	D <sub>1</sub> (H8)	D <sub>2</sub> (H8)	A (±0.30)	B	C (max)
6SB-10		10	23	27	4.2	4.1	9
6SB-12		12(13)	25	32	4.7	5.4	9.5
6SB-16		16(17)	30	41	6.8	5.4	9.5
6SB-20		20	35	45	6.8	5.4	10.5
6SB-25		25	44	52	8.5	7	11.5
6SB-30		30	48	58	8.5	8	12.5

